

# Board of Supervisors Committee of the Whole

--  
**Scott County Courthouse  
Pedestrian Walkway & Parking Lot Improvement Project**

--  
Scott County Iowa

May 2, 2017



Bracke . Hayes . Miller . Mahon, Architects, LLP  
Moline, Illinois Davenport, Iowa

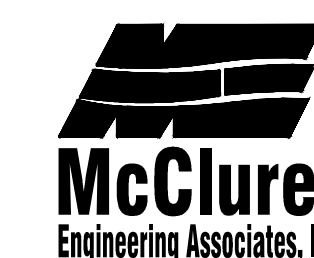

IEFM CONSULTING ENGINEERS  
COAL VALLEY, ILLINOIS

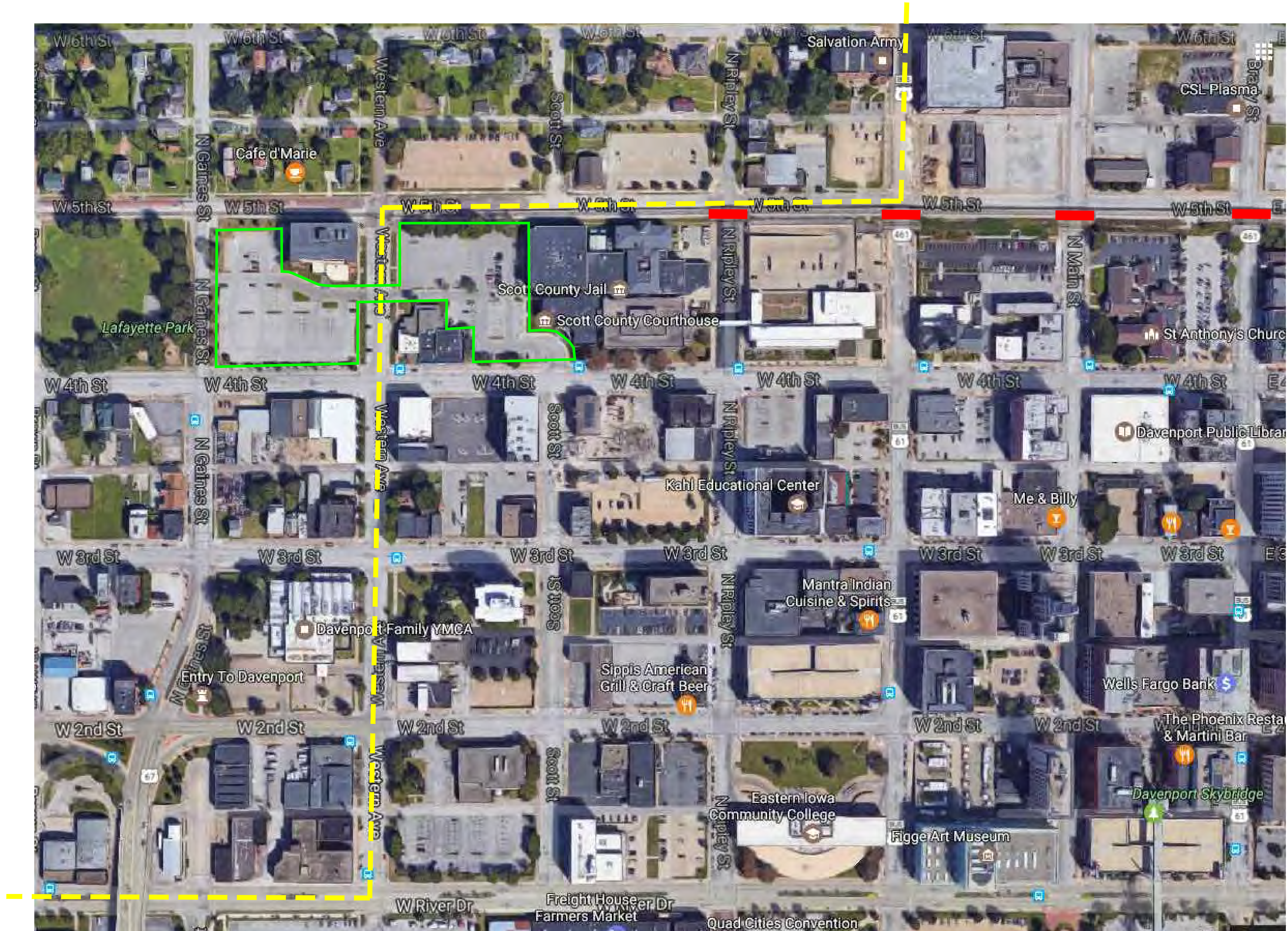





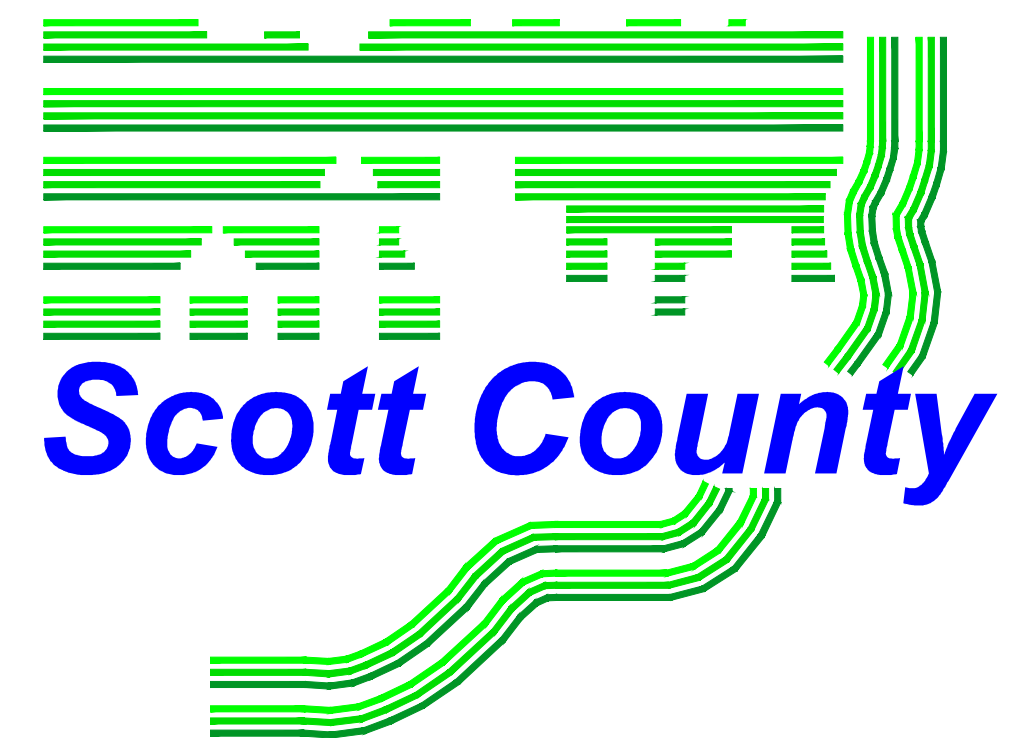

Bracke . Hayes . Miller . Mahon, Architects, LLP  
Moline, Illinois Davenport, Iowa

# Scott County Courthouse Pedestrian Walkway & Parking Lot Improvement Project

Facility and Support Services  
Scott County, Iowa  
Davenport, Iowa



Bracke  
Hayes  
Miller  
Mahon,  
Architects LLP

1465 41st Street  
Moline, Illinois 61265  
309.762.0511  
1315 East 11th Street  
Davenport, Iowa 52803  
563.323.8484

Scott County Courthouse  
Pedestrian Walkway & Parking Lot  
Improvement Project  
300 West 4th Street  
Facility and Support Services  
Scott County, Davenport Iowa

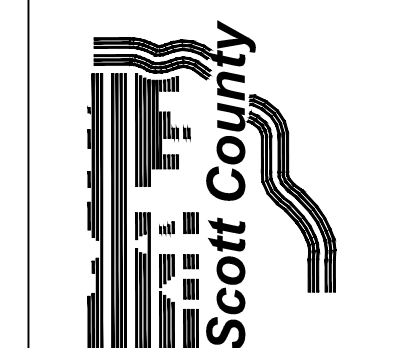

4-25-17  
Copyright 2017  
Project No. 1620

DEMOLITION  
EAST SITE PLAN

1

1 of 10

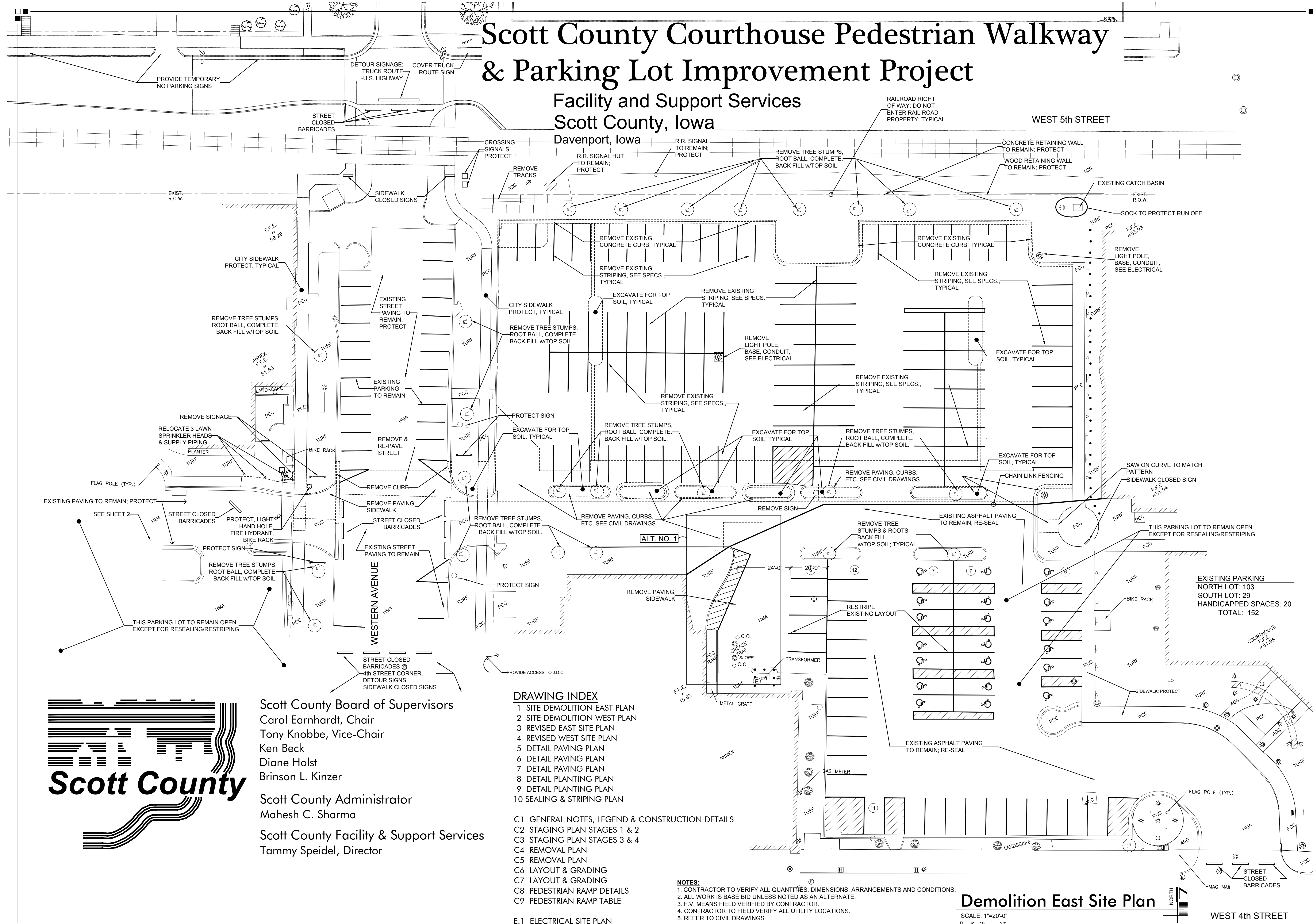

### DRAWING INDEX

- 1 SITE DEMOLITION EAST PLAN
- 2 SITE DEMOLITION WEST PLAN
- 3 REVISED EAST SITE PLAN
- 4 REVISED WEST SITE PLAN
- 5 DETAIL PAVING PLAN
- 6 DETAIL PAVING PLAN
- 7 DETAIL PAVING PLAN
- 8 DETAIL PLANTING PLAN
- 9 DETAIL PLANTING PLAN
- 10 SEALING & STRIPING PLAN
- C1 GENERAL NOTES, LEGEND & CONSTRUCTION DETAILS
- C2 STAGING PLAN STAGES 1 & 2
- C3 STAGING PLAN STAGES 3 & 4
- C4 REMOVAL PLAN
- C5 REMOVAL PLAN
- C6 LAYOUT & GRADING
- C7 LAYOUT & GRADING
- C8 PEDESTRIAN RAMP DETAILS
- C9 PEDESTRIAN RAMP TABLE
- E.1 ELECTRICAL SITE PLAN

**NOTES:**  
 1. CONTRACTOR TO VERIFY ALL QUANTITIES, DIMENSIONS, ARRANGEMENTS AND CONDITIONS.  
 2. ALL WORK IS BASE BID UNLESS NOTED AS AN ALTERNATE.  
 3. F.V. MEANS FIELD VERIFIED BY CONTRACTOR.  
 4. CONTRACTOR TO FIELD VERIFY ALL UTILITY LOCATIONS.  
 5. REFER TO CIVIL DRAWINGS  
 ----- MATERIALS TO BE REMOVED

### Demolition East Site Plan

SCALE: 1"=20'-0"  
 0' 5' 10' 20'

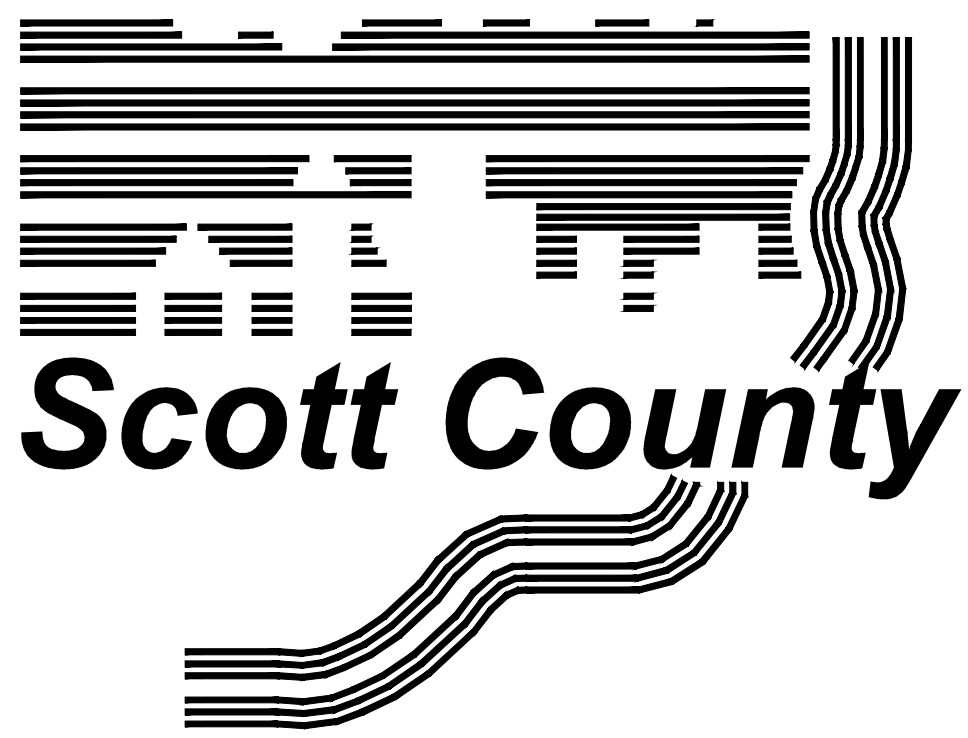

Scott County Board of Supervisors  
 Carol Earnhardt, Chair  
 Tony Knobbe, Vice-Chair  
 Ken Beck  
 Diane Holst  
 Brinson L. Kinzer  
 Scott County Administrator  
 Mahesh C. Sharma  
 Scott County Facility & Support Services  
 Tammy Speidel, Director

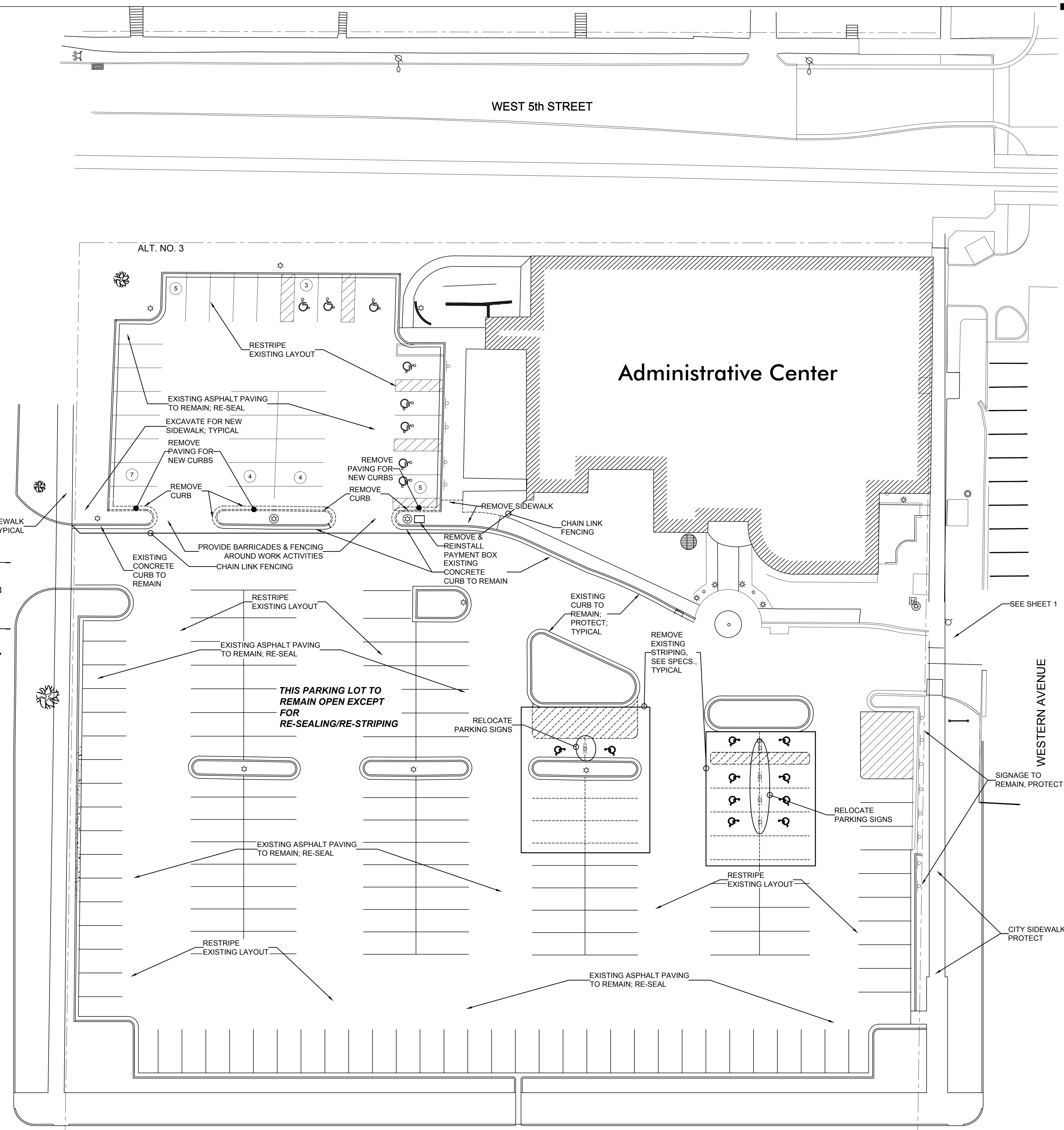
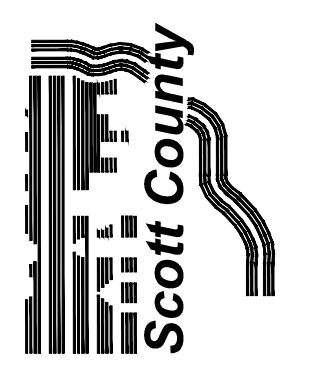

**EXISTING PARKING**  
NORTHWEST LOT: 23  
HANDICAPPED SPACES: 8  
TOTAL: 31

**REVISED PARKING**  
NORTHWEST LOT: 21  
HANDICAPPED SPACES: 7  
TOTAL: 28

**NOTES:**  
1. CONTRACTOR TO VERIFY ALL QUANTITIES, DIMENSIONS, ARRANGEMENTS AND CONDITIONS.  
2. ALL WORK IS BASE BID UNLESS NOTED AS AN ALTERNATE.  
3. F.V. MEANS FIELD VERIFIED BY CONTRACTOR.  
4. CONTRACTOR TO FIELD VERIFY ALL UTILITY LOCATIONS.  
5. REFER TO CIVIL DRAWINGS  
----- MATERIALS TO BE REMOVED

**Demolition West Site Plan**

SCALE: 1"=20'-0"  
0 5' 10' 20'



WEST 4th STREET

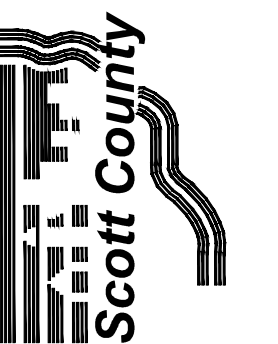

4-25-17

Copyright 2017

Project No. 1620

REVISED EAST  
SITE PLAN

3

3 of 10

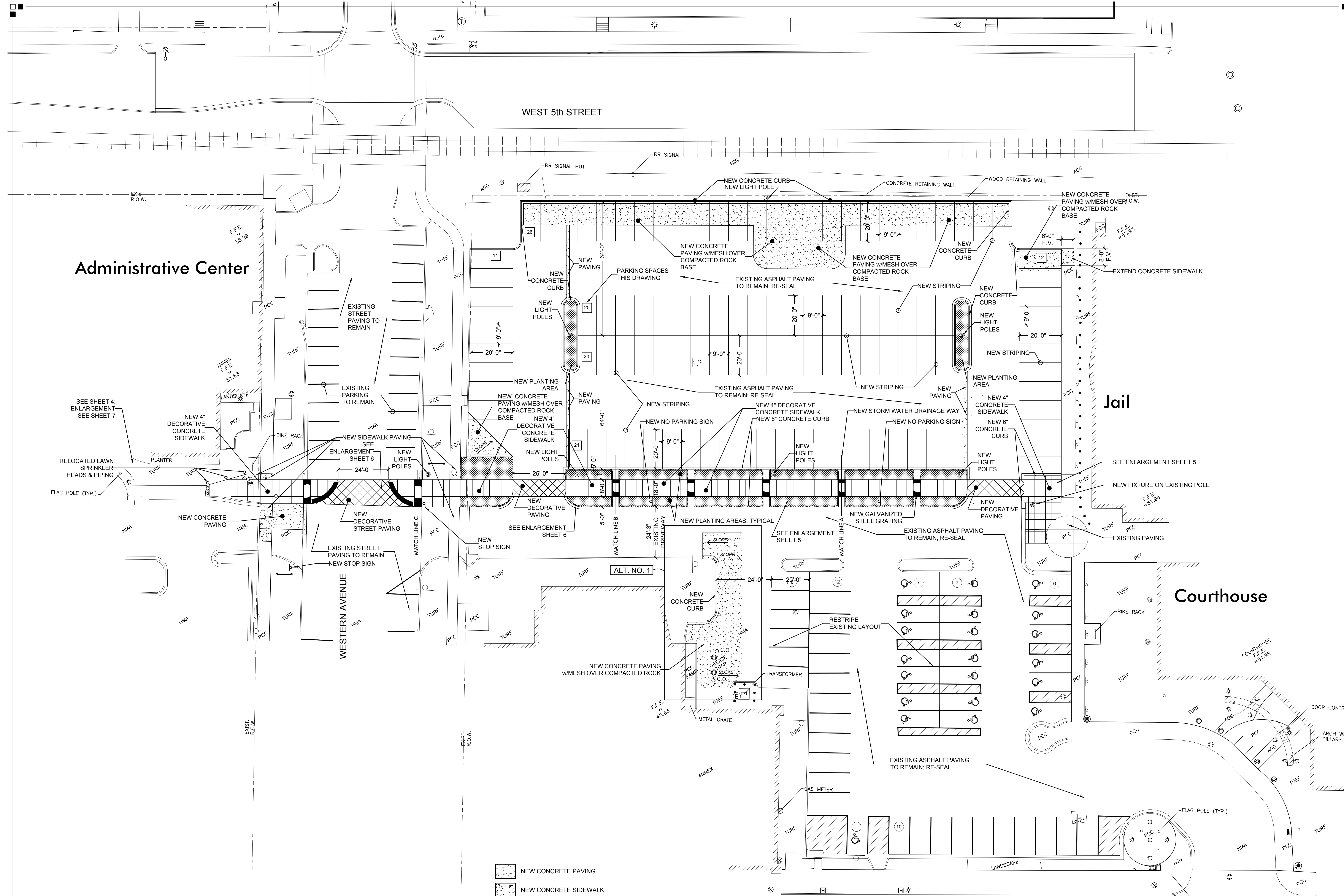

- NEW CONCRETE PAVING
- NEW CONCRETE SIDEWALK

NOTES:  
 1. CONTRACTOR TO VERIFY ALL QUANTITIES, DIMENSIONS, ARRANGEMENTS AND CONDITIONS.  
 2. ALL WORK IS BASE BID UNLESS NOTED AS AN ALTERNATE.  
 3. F.V. MEANS FIELD VERIFIED BY CONTRACTOR.  
 4. CONTRACTOR TO FIELD VERIFY ALL UTILITY LOCATIONS.

Revised East Site Plan

SCALE: 1"=20'-0"  
 0 5' 10' 20'



WEST 4th STREET



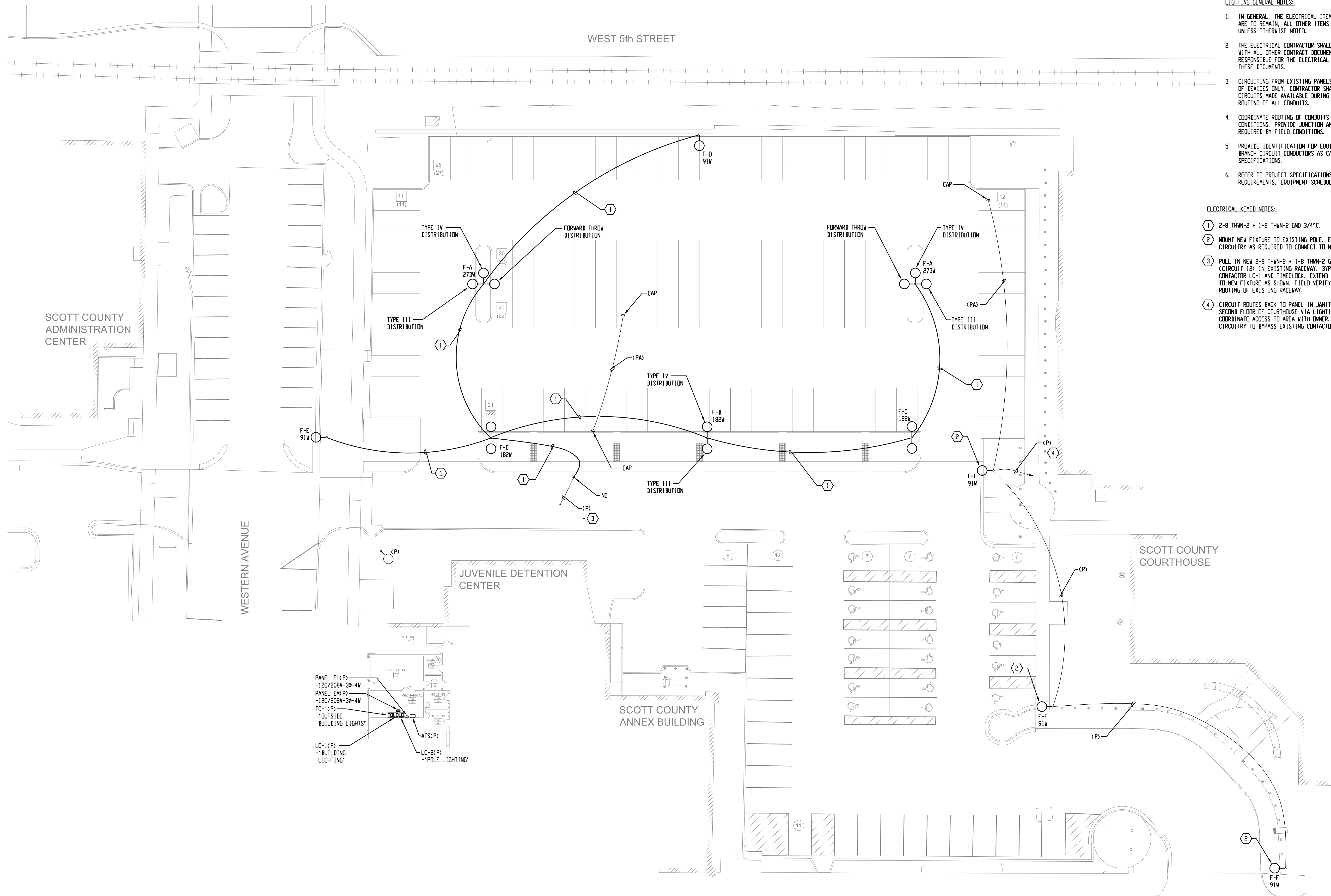

- LIGHTING GENERAL NOTES:**
1. IN GENERAL, THE ELECTRICAL ITEMS SHOWN LIGHTLY ARE TO REMAIN, ALL OTHER ITEMS SHALL BE NEW UNLESS OTHERWISE NOTED.
  2. THE ELECTRICAL CONTRACTOR SHALL BECOME FAMILIAR WITH ALL OTHER CONTRACT DOCUMENTS, AND SHALL BE RESPONSIBLE FOR THE ELECTRICAL WORK REQUIRED BY THESE DOCUMENTS.
  3. CIRCUITING FROM EXISTING PANELS IS FOR GROUPING OF DEVICES ONLY. CONTRACTOR SHALL VERIFY EXISTING CIRCUITS MADE AVAILABLE DURING DEMOLITION AND ROUTING OF ALL CONDUITS.
  4. COORDINATE ROUTING OF CONDUITS WITH EXISTING CONDITIONS. PROVIDE JUNCTION AND/OR PULL BOXES AS REQUIRED BY FIELD CONDITIONS.
  5. PROVIDE IDENTIFICATION FOR EQUIPMENT, DEVICES & BRANCH CIRCUIT CONDUCTORS AS CALLED FOR IN THE SPECIFICATIONS.
  6. REFER TO PROJECT SPECIFICATIONS FOR ADDITIONAL REQUIREMENTS, EQUIPMENT SCHEDULES AND DETAILS.

- ELECTRICAL KEYED NOTES:**
- 1 2-8 THWN-2 + 1-8 THWN-2 GND 3/4" C.
  - 2 MOUNT NEW FIXTURE TO EXISTING POLE. EXTEND EXISTING CIRCUITRY AS REQUIRED TO CONNECT TO NEW FIXTURE.
  - 3 PULL IN NEW 2-8 THWN-2 + 1-8 THWN-2 GND FROM PANEL EL(P) (CIRCUIT 12) IN EXISTING RACEWAY. BYPASS EXISTING CONTACTOR LC-1 AND TIMECLOCK. EXTEND EXISTING RACEWAY TO NEW FIXTURE AS SHOWN. FIELD VERIFY LOCATION AND ROUTING OF EXISTING RACEWAY.
  - 4 CIRCUIT ROUTES BACK TO PANEL IN JANITOR'S CLOSET ON SECOND FLOOR OF COURTHOUSE VIA LIGHTING CONTACTOR. COORDINATE ACCESS TO AREA WITH OWNER. REWORK EXISTING CIRCUITRY TO BYPASS EXISTING CONTACTOR AND TIMECLOCK.

PANEL EL(P)  
-120/208Y-3Ø-4W  
PANEL EM(P)  
-120/208Y-3Ø-4W  
TC-1(P)  
-OUTSIDE BUILDING LIGHTS  
LC-1(P)  
-BUILDING LIGHTING  
ATSC(P)  
LC-2(P)  
-POLE LIGHTING

**ELECTRICAL SITE PLAN**  
SCALE: 1" = 20'-0"

**IEFM CONSULTING ENGINEERS**  
♦ MECHANICAL ♦ ELECTRICAL ♦ ENERGY CONSERVATION ♦  
128 EAST 23RD AVENUE, P.O. BOX 130  
COAL VALLEY, ILLINOIS 61240  
PHONE (309) 799-5150  
FAX (309) 799-5190  
IEFM@IEFMCONSULTINGENGINEERS.COM

**BMM**  
**Bracke  
Hayes  
Miller  
Mahon,  
Architects LLP**  
1465 41st Street  
Moline, Illinois 61265  
309.762.0511  
1315 East 11th Street  
Davenport, Iowa 52803  
563.323.8484

**Scott County Courthouse  
Pedestrian Walkway & Parking Lot  
Improvement Project**  
300 West 4th Street  
Facility and Support Services  
Scott County, Davenport Iowa

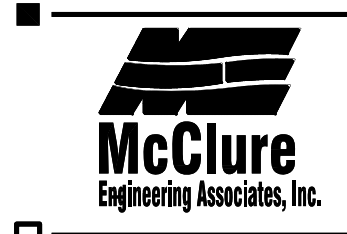
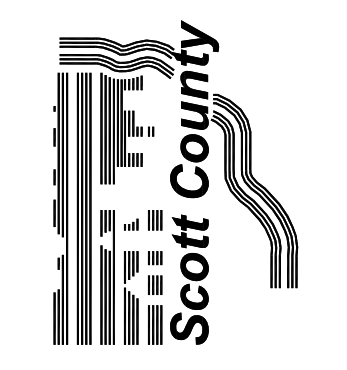

04-25-17  
Copyright 2017  
Project No. 1620

**ELECTRICAL SITE PLAN**  
**E.1**  
of

H:\2016\16-14\dwg\16-14-EL.dwg, 4/27/2017 8:10:19 AM

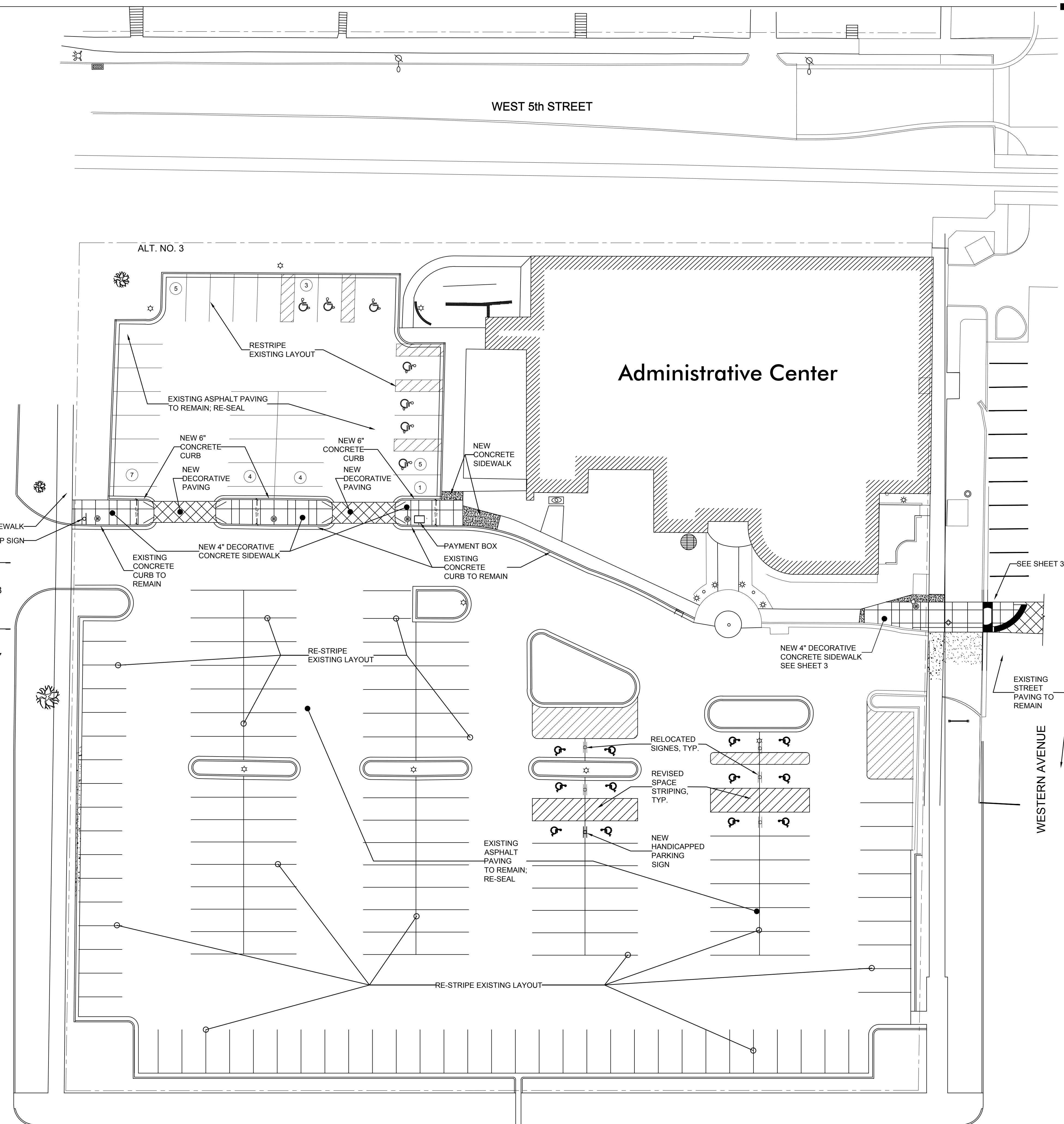
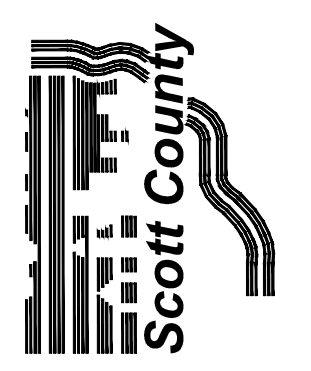

**EXISTING PARKING**  
NORTHWEST LOT: 23  
HANDICAPPED SPACES: 8  
TOTAL: 31

**REVISED PARKING**  
NORTHWEST LOT: 21  
HANDICAPPED SPACES: 7  
TOTAL: 28

NEW CONCRETE PAVING  
 NEW CONCRETE SIDEWALK

**NOTES:**  
1. CONTRACTOR TO VERIFY ALL QUANTITIES, DIMENSIONS, ARRANGEMENTS AND CONDITIONS.  
2. ALL WORK IS BASE BID UNLESS NOTED AS AN ALTERNATE.  
3. F.V. MEANS FIELD VERIFIED BY CONTRACTOR.  
4. CONTRACTOR TO FIELD VERIFY ALL UTILITY LOCATIONS.

**Revised West Site Plan**

SCALE: 1"=20'-0"  
0 5' 10' 20'

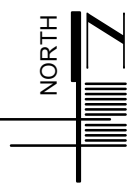

WEST 4th STREET

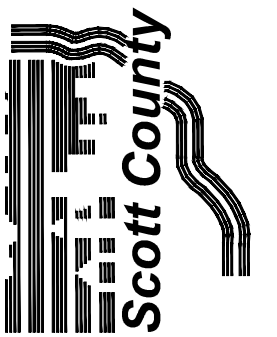

4-25-17

Copyright 2017

Project No. 1620

Detail Paving  
Plan

5

5 of 10

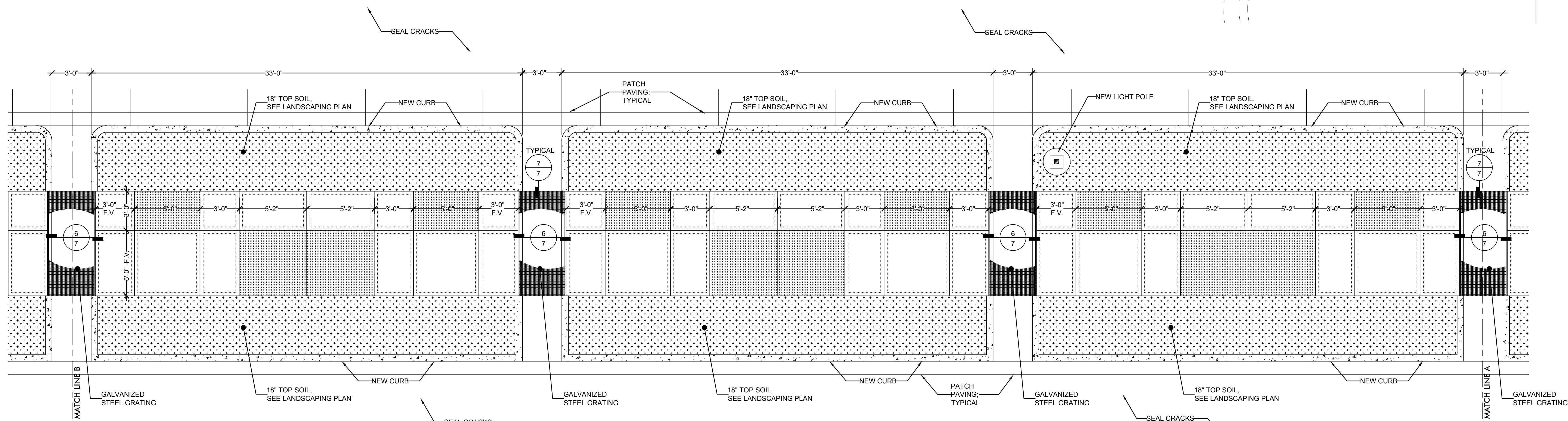
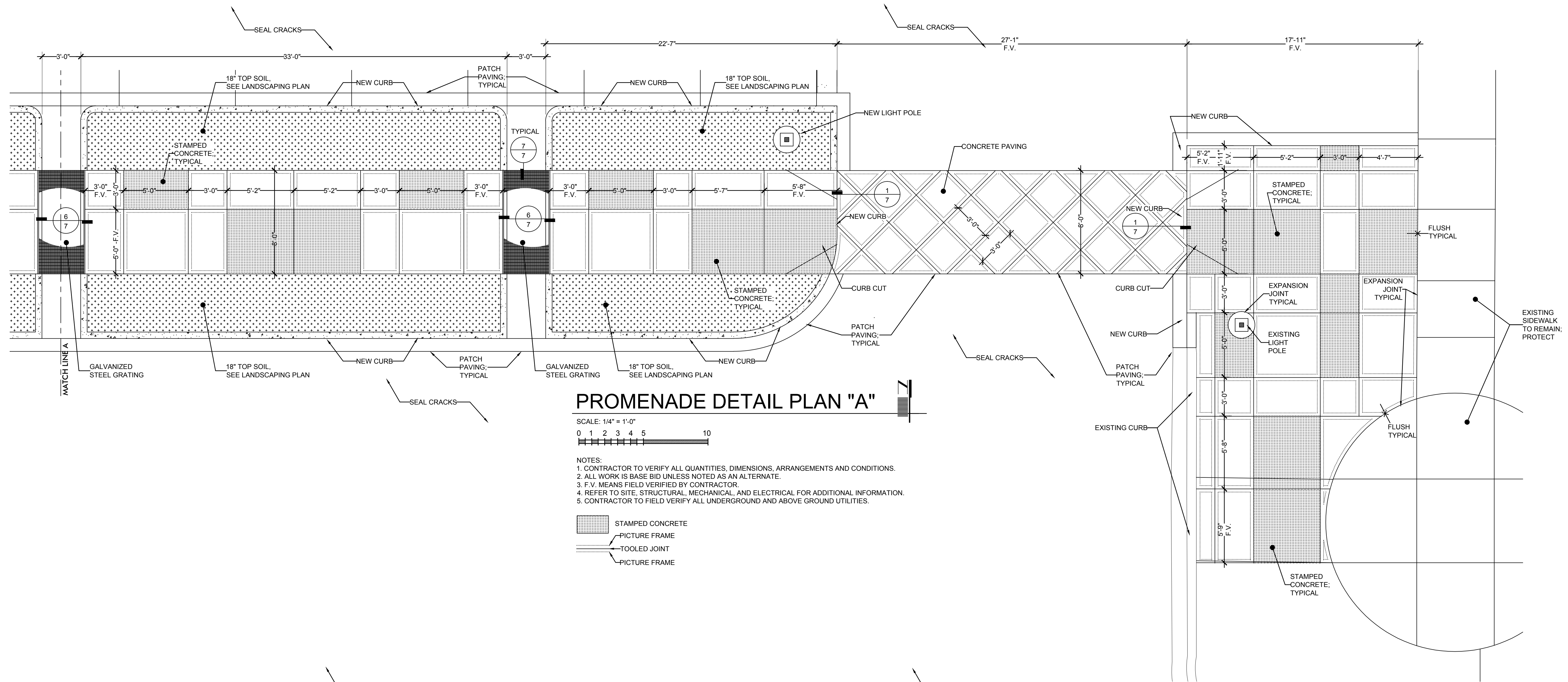



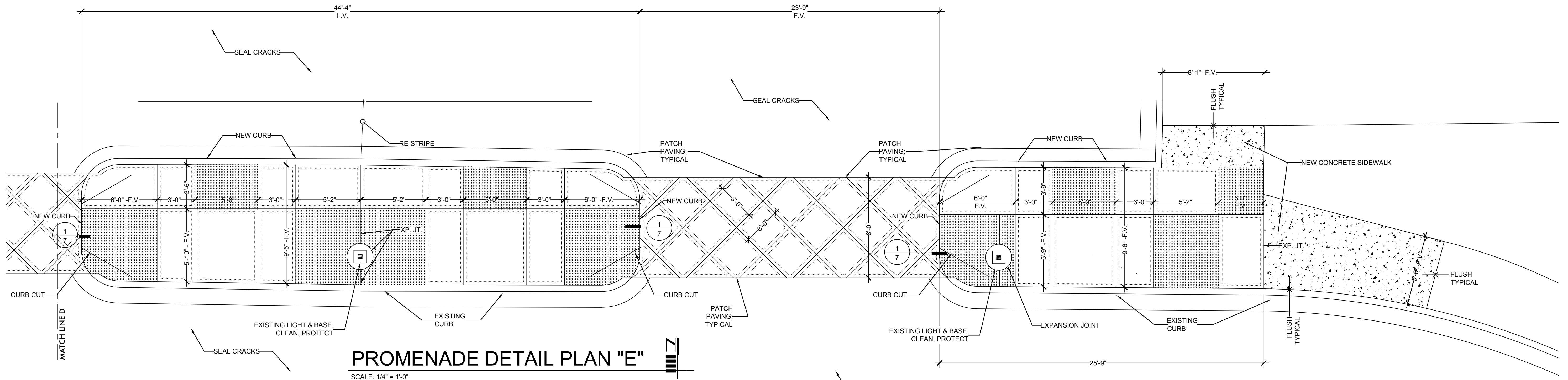

**PROMENADE DETAIL PLAN "E"**

SCALE: 1/4" = 1'-0"  
0 1 2 3 4 5 10

- NOTES:  
1. CONTRACTOR TO VERIFY ALL QUANTITIES, DIMENSIONS, ARRANGEMENTS AND CONDITIONS.  
2. ALL WORK IS BASE BID UNLESS NOTED AS AN ALTERNATE.  
3. F.V. MEANS FIELD VERIFIED BY CONTRACTOR.  
4. REFER TO SITE, STRUCTURAL, MECHANICAL, AND ELECTRICAL FOR ADDITIONAL INFORMATION.  
5. CONTRACTOR TO FIELD VERIFY ALL UNDERGROUND AND ABOVE GROUND UTILITIES.

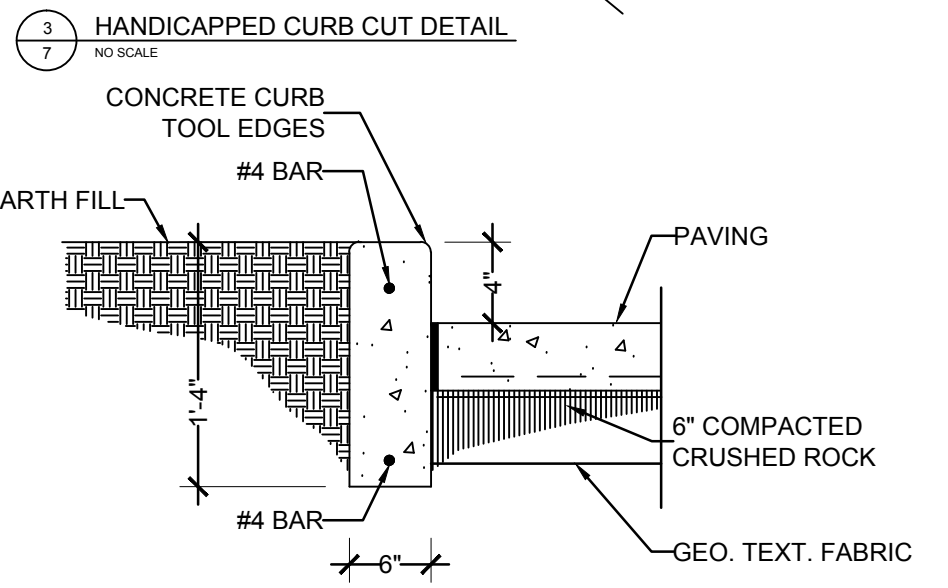
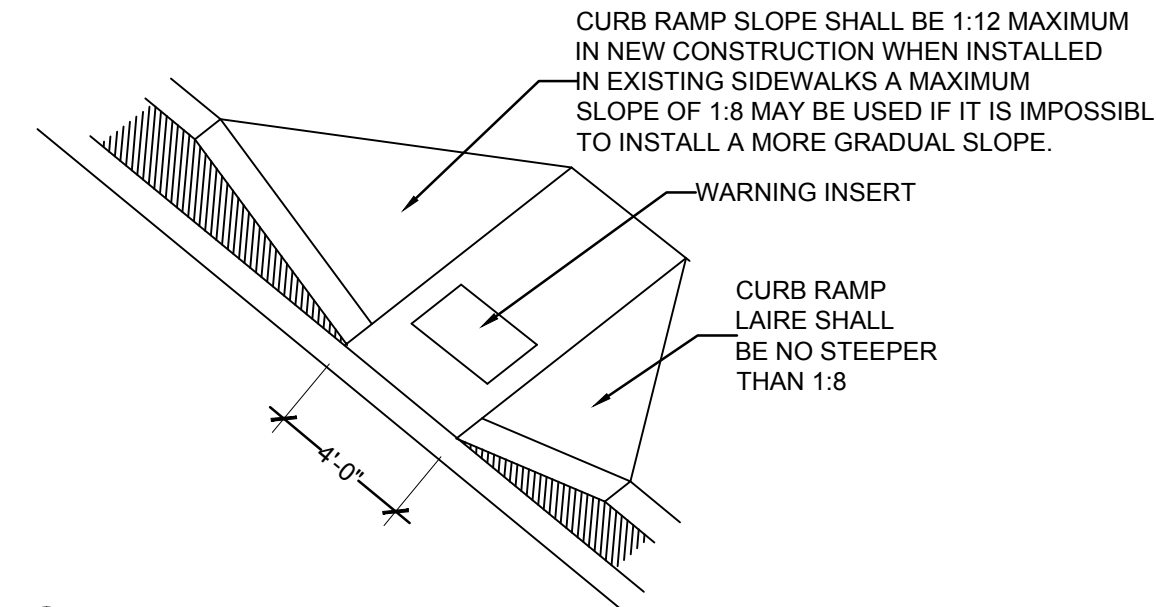

3 HANDICAPPED CURB CUT DETAIL  
NO SCALE

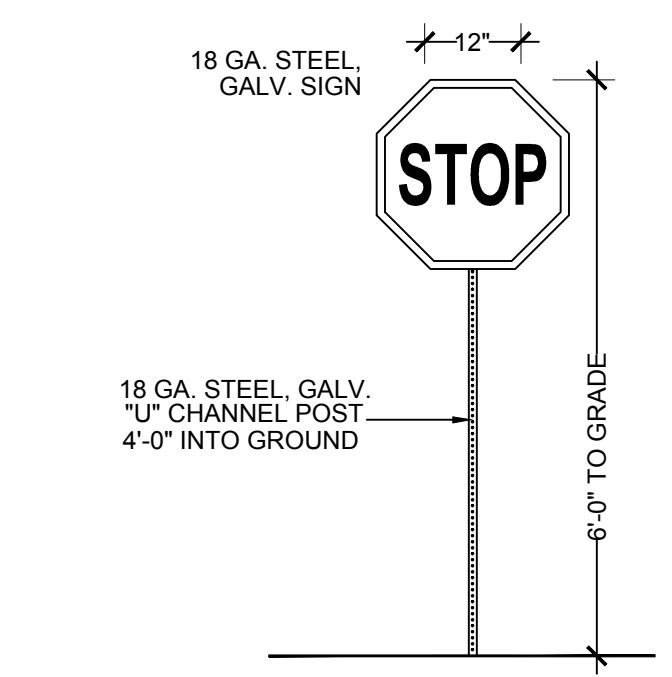

4 CONCRETE CURB DETAIL  
NO SCALE



5 STOP SIGN DETAIL  
NOT TO SCALE

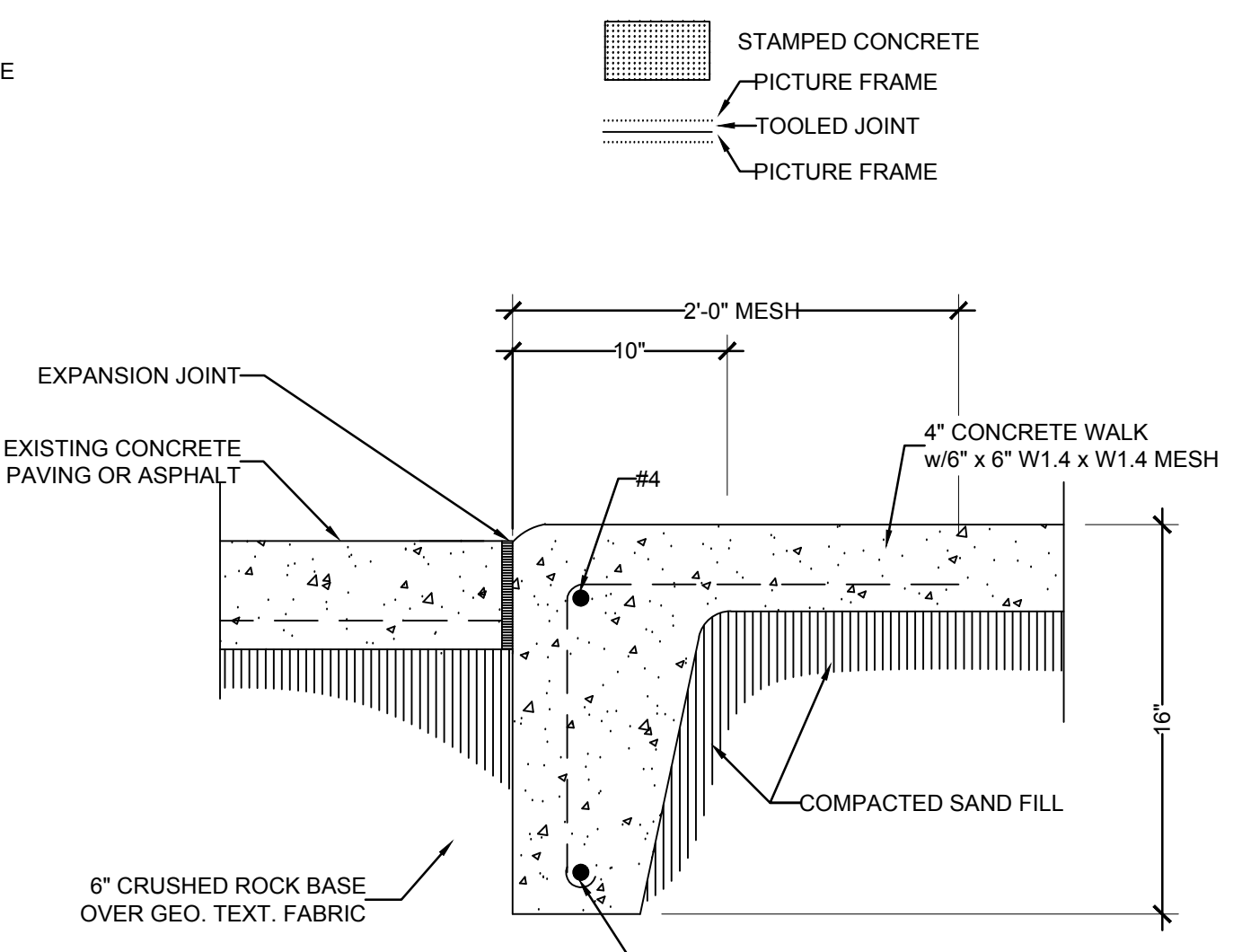

1 CONCRETE PAVING CURB DETAIL  
Scale: 1/2" = 1'-0"

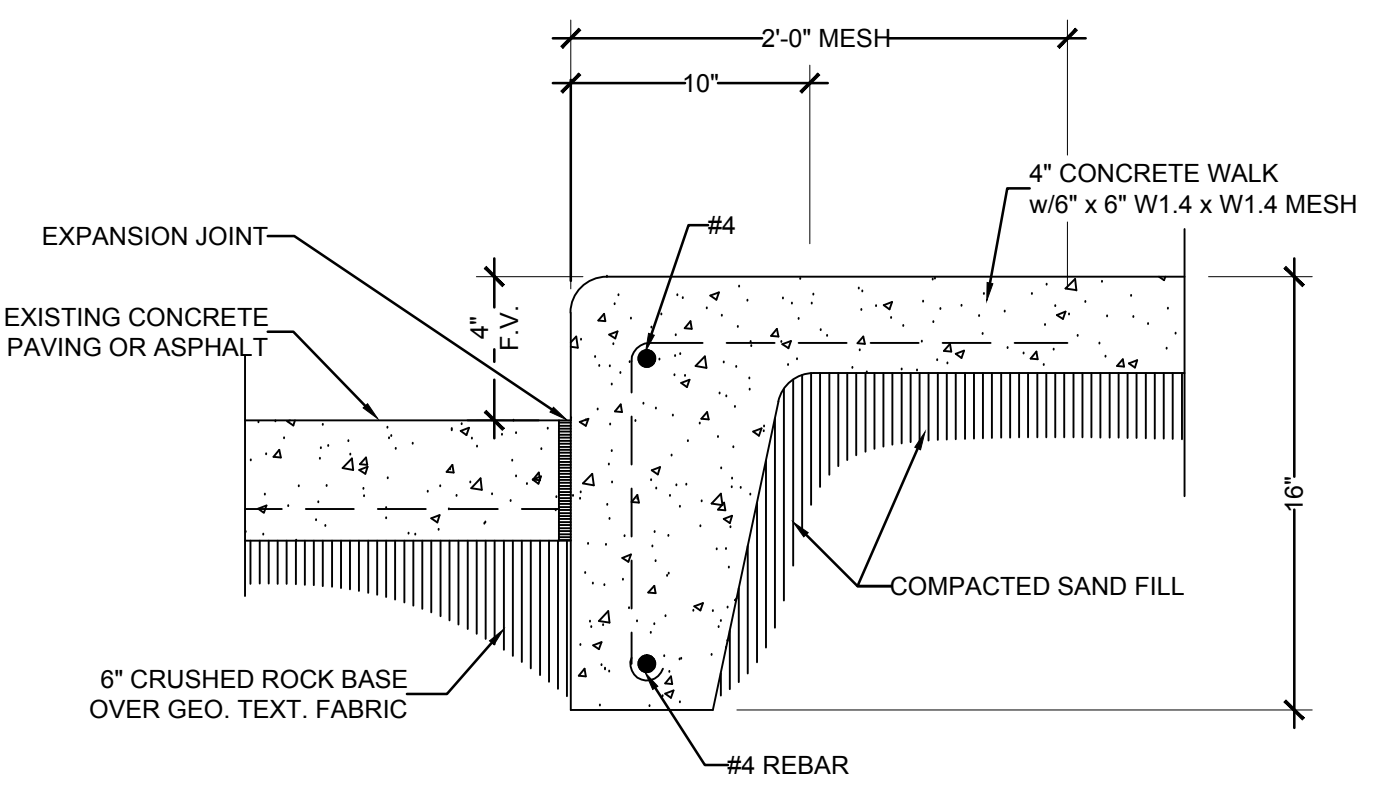

2 CONCRETE PAVING CURB DETAIL  
Scale: 1/2" = 1'-0"

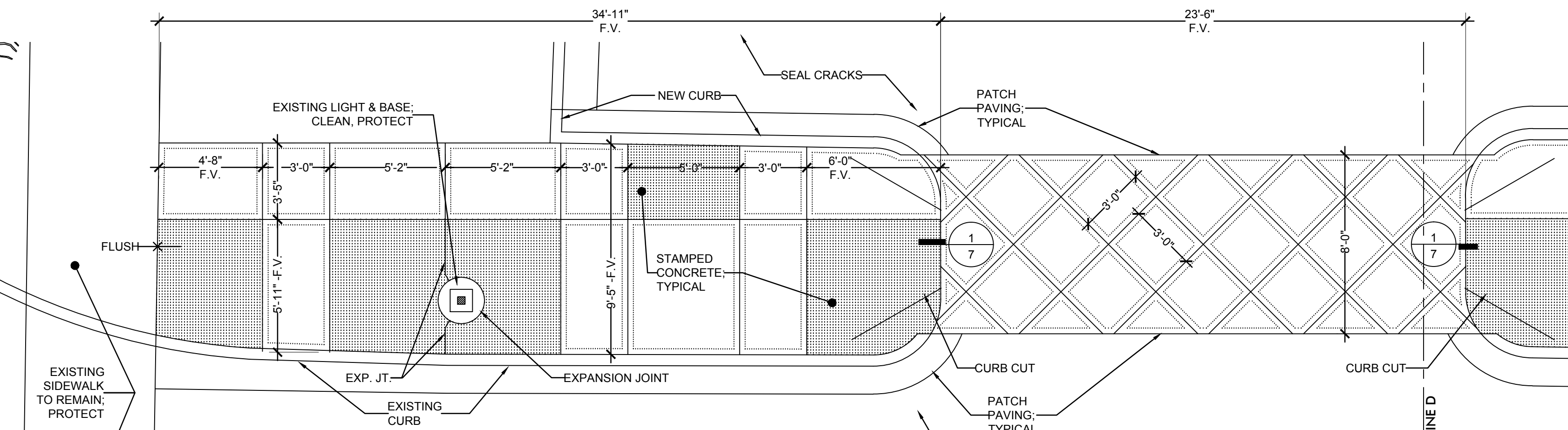

**PROMENADE DETAIL PLAN "F"**

SCALE: 1/4" = 1'-0"  
0 1 2 3 4 5 10

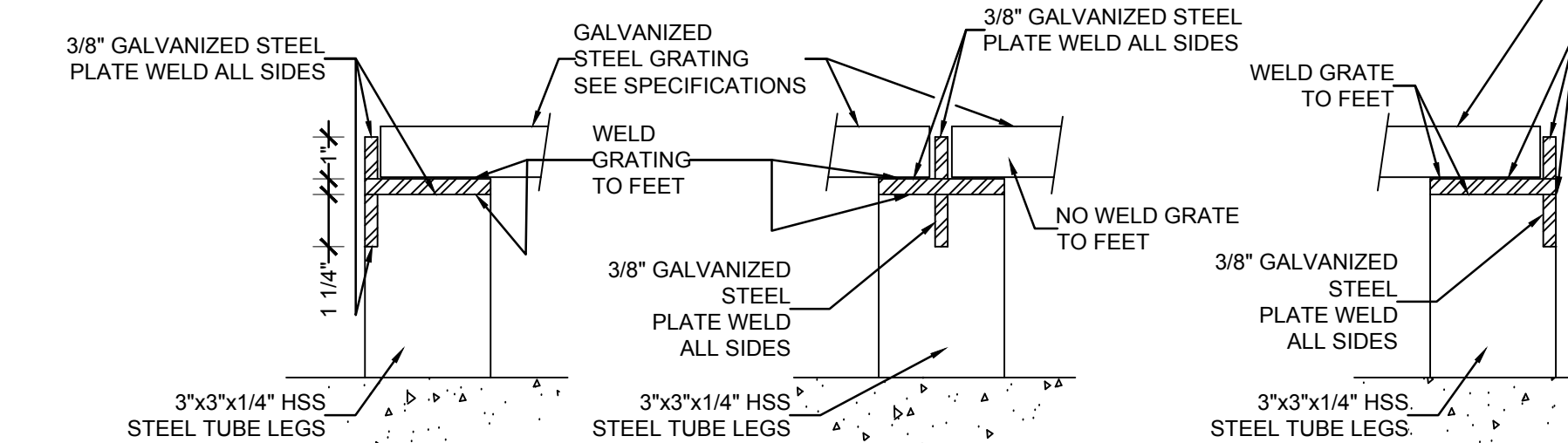
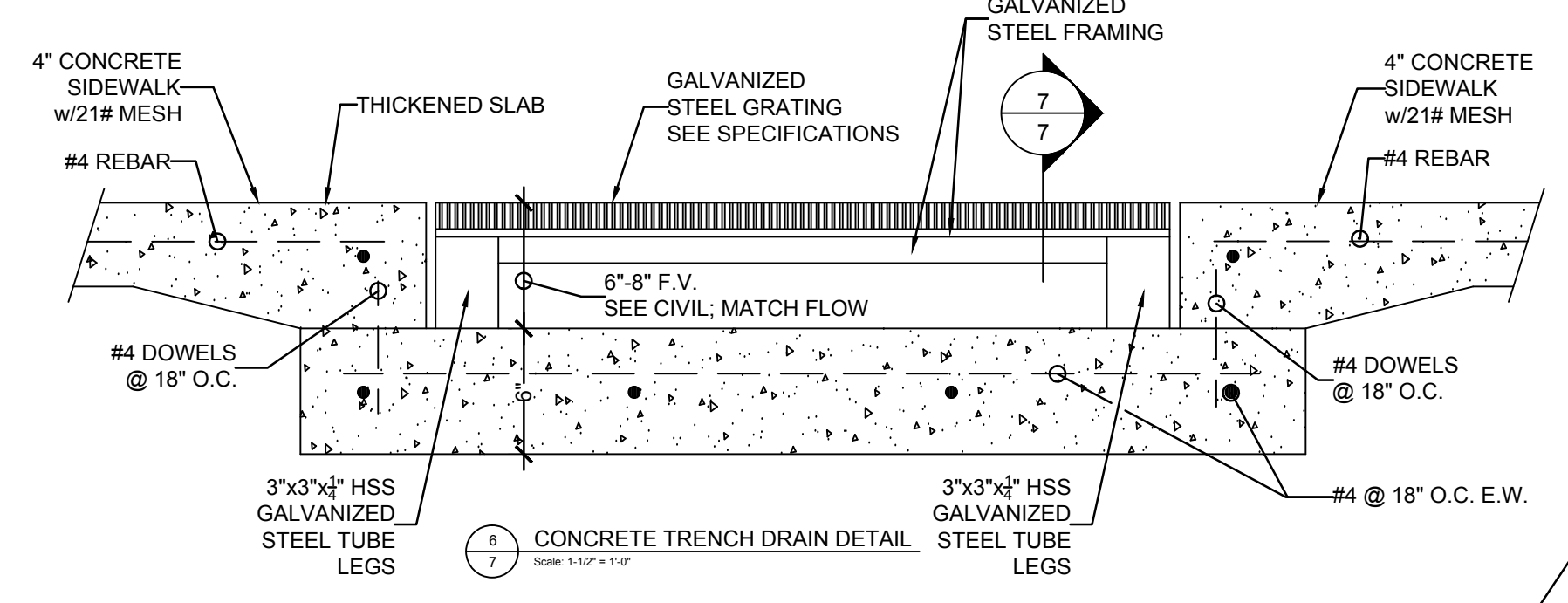

7 STEEL GRATING AND SUPPORT DETAIL  
Scale: 3/4" = 1'-0"

NOTE: HOT DIP GALVANIZED STEEL GRATING, PLATES, TUBES, ETC. AFTER FABRICATION

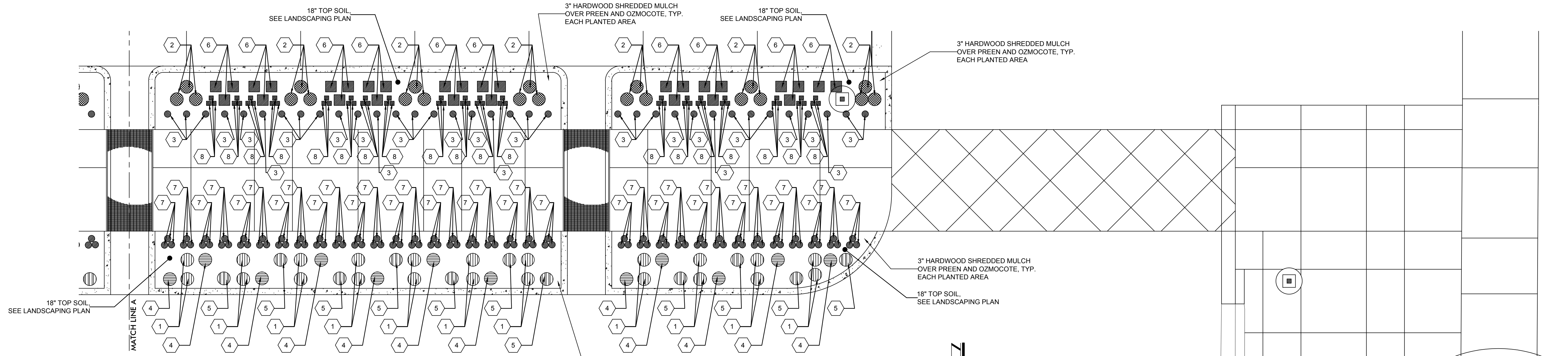

**PLANTING DETAIL PLAN "A"**

SCALE: 1/4" = 1'-0"  
0 1 2 3 4 5 10

- NOTES:
1. CONTRACTOR TO VERIFY ALL QUANTITIES, DIMENSIONS, ARRANGEMENTS AND CONDITIONS.
  2. ALL WORK IS BASE BID UNLESS NOTED AS AN ALTERNATE.
  3. F.V. MEANS FIELD VERIFIED BY CONTRACTOR.
  4. REFER TO SITE, STRUCTURAL, MECHANICAL, AND ELECTRICAL FOR ADDITIONAL INFORMATION.
  5. CONTRACTOR TO FIELD VERIFY ALL UNDERGROUND AND ABOVE GROUND UTILITIES.

**PLANTING SCHEDULE**

- 1 PURPLE MOOR GRASS: MOLINIA CAERULEA "SKYRACER" 3/4 GALLON POT, EACH
- 2 LITTLE BLUE STEM GRASS: SCHIZACHYRIUM SCOPARIUM "PRAIRIE BLUES" 2 1/2" POT, EACH
- 3 ALLIUM "PURPLE SENSATION" PLANT AT 18" O.C. IN A LINE BULB, EACH
- 4 BEE BALM: MONARDA "JACOB CLINE" 1 PINT POT, EACH
- 5 CONEFLOWER: ECHINACEA PURPUREA "WHITE SWAN" 1 PINT POT, EACH
- 6 DAY LILLY: HEMEROCALLIS "STELLA DE ORO", REBLOOMING 3/4 GALLON POT, EACH
- 7 DAFFODILS: NARCISSUS ICE FOLLIES (LARGE, WHITE/YELLOW) PLANT IN GROUPS, EACH GROUP IN A LINE BULB, EACH
- 8 DAFFODILS: NARCISSUS PRIDE OF LIONS (LARGE, YELLOW/YELLOW) PLANT IN GROUPS, EACH GROUP IN A LINE BULB, EACH

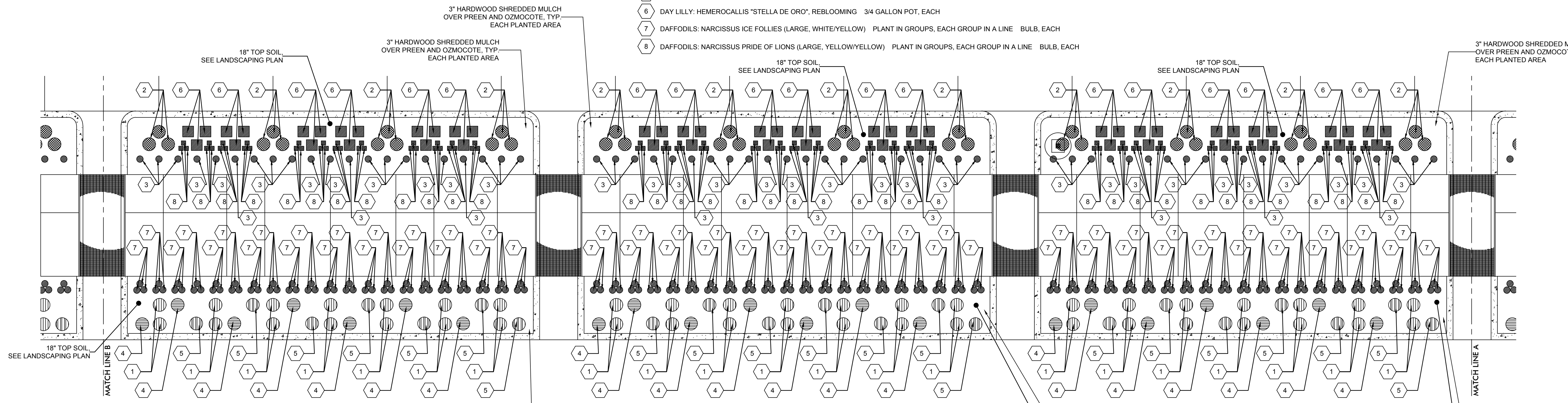

**PLANTING DETAIL PLAN "B"**

SCALE: 1/4" = 1'-0"

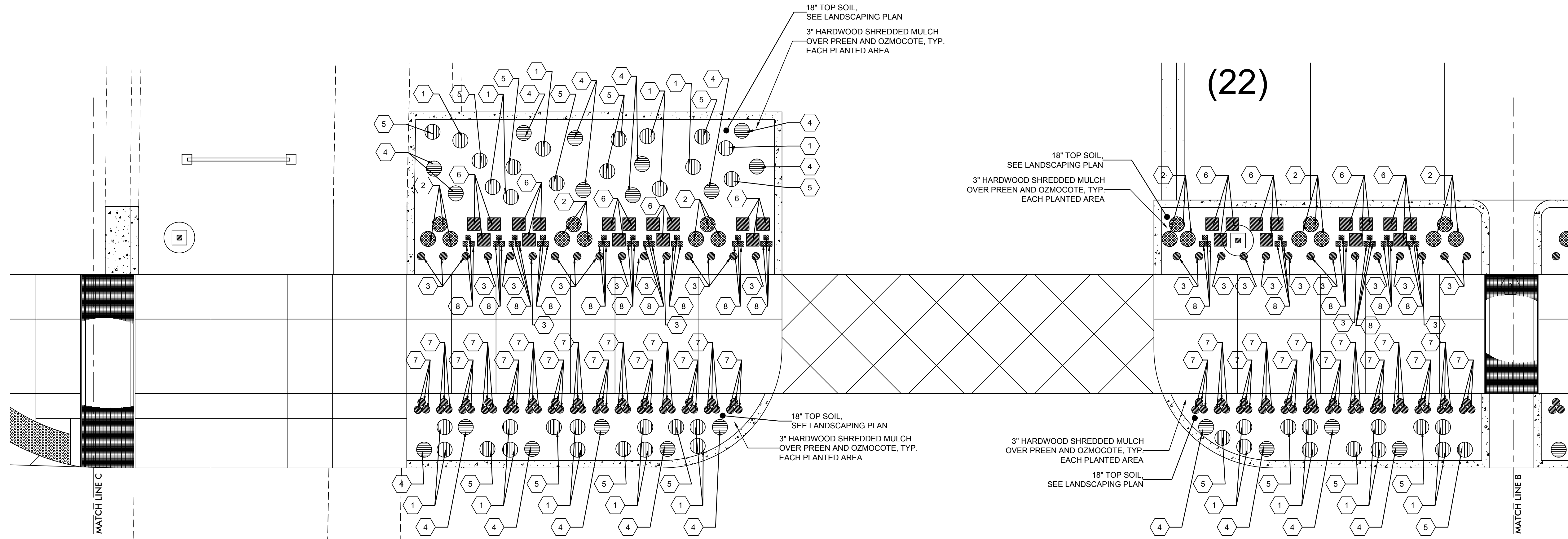

### PLANTING DETAIL PLAN "C"

SCALE: 1/4" = 1'-0"  
 0 1 2 3 4 5 10

- NOTES:
1. CONTRACTOR TO VERIFY ALL QUANTITIES, DIMENSIONS, ARRANGEMENTS AND CONDITIONS.
  2. ALL WORK IS BASE BID UNLESS NOTED AS AN ALTERNATE.
  3. F.V. MEANS FIELD VERIFIED BY CONTRACTOR.
  4. REFER TO SITE, STRUCTURAL, MECHANICAL, AND ELECTRICAL FOR ADDITIONAL INFORMATION.
  5. CONTRACTOR TO FIELD VERIFY ALL UNDERGROUND AND ABOVE GROUND UTILITIES.

#### PLANTING SCHEDULE

- |   |   |  |
|---|---|--|
| 1 | PURPLE MOOR GRASS: MOLINIA CAERULEA "SKYRACER"                  | 3/4 GALLON POT, EACH                             |
| 2 | LITTLE BLUE STEM GRASS: SCHIZACHYRIUM SCOPARIUM "PRAIRIE BLUES" | 2 1/2" POT, EACH                                 |
| 3 | ALLIUM "PURPLE SENSATION"                                       | PLANT AT 18" O.C. IN A LINE BULB, EACH           |
| 4 | BEE BALM: MONARDA "JACOB CLINE"                                 | 1 PINT POT, EACH                                 |
| 5 | CONEFLOWER: ECHINACEA PURPUREA "WHITE SWAN"                     | 1 PINT POT, EACH                                 |
| 6 | DAY LILLY: HEMEROCALLIS "STELLA DE ORO", REBLOOMING             | 3/4 GALLON POT, EACH                             |
| 7 | DAFFODILS: NARCISSUS ICE FOLLIES (LARGE, WHITE/YELLOW)          | PLANT IN GROUPS, EACH GROUP IN A LINE BULB, EACH |
| 8 | DAFFODILS: NARCISSUS PRIDE OF LIONS (LARGE, YELLOW/YELLOW)      | PLANT IN GROUPS, EACH GROUP IN A LINE BULB, EACH |

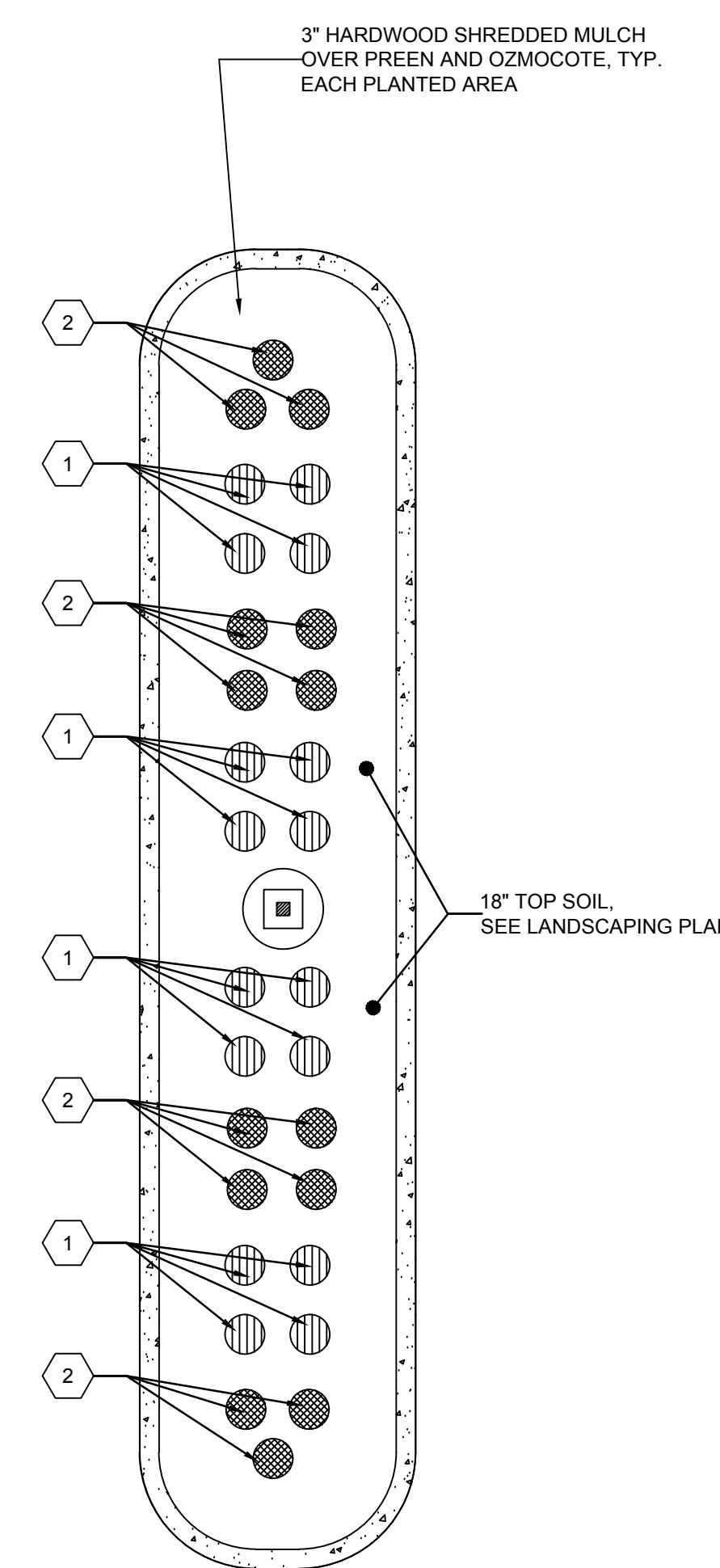

### PLANTING DETAIL PLAN ISLAND

SCALE: 1/4" = 1'-0"

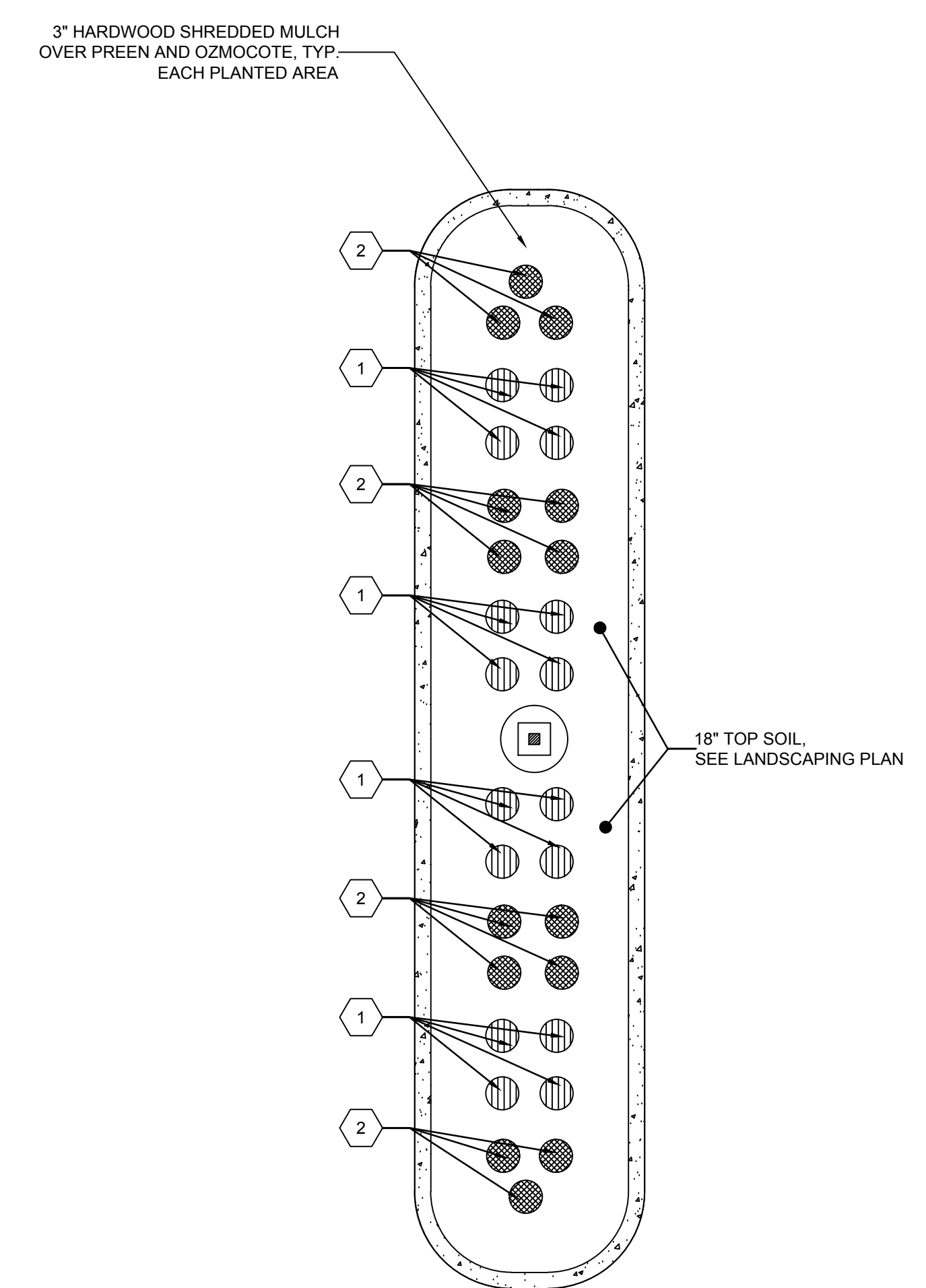

### PLANTING DETAIL PLAN ISLAND

SCALE: 1/4" = 1'-0"



**Bracke  
Hayes  
Miller  
Mahon,  
Architects LLP**

1465 41st Street  
Moline, Illinois 61265  
309.762.0511  
1315 East 11th Street  
Davenport, Iowa 52803  
563.323.8484

**Scott County Courthouse  
Pedestrian Walkway & Parking Lot  
Improvement Project**  
300 West 4th Street  
Davenport, Iowa 52803  
Facility and Support Services  
Scott County, Davenport Iowa

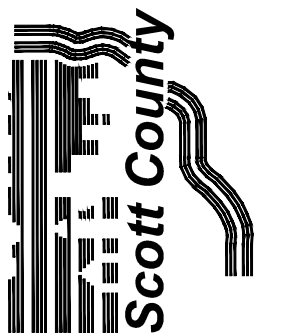

4-25-17

Copyright 2017

Project No. 1620

Detail Planting  
Plan

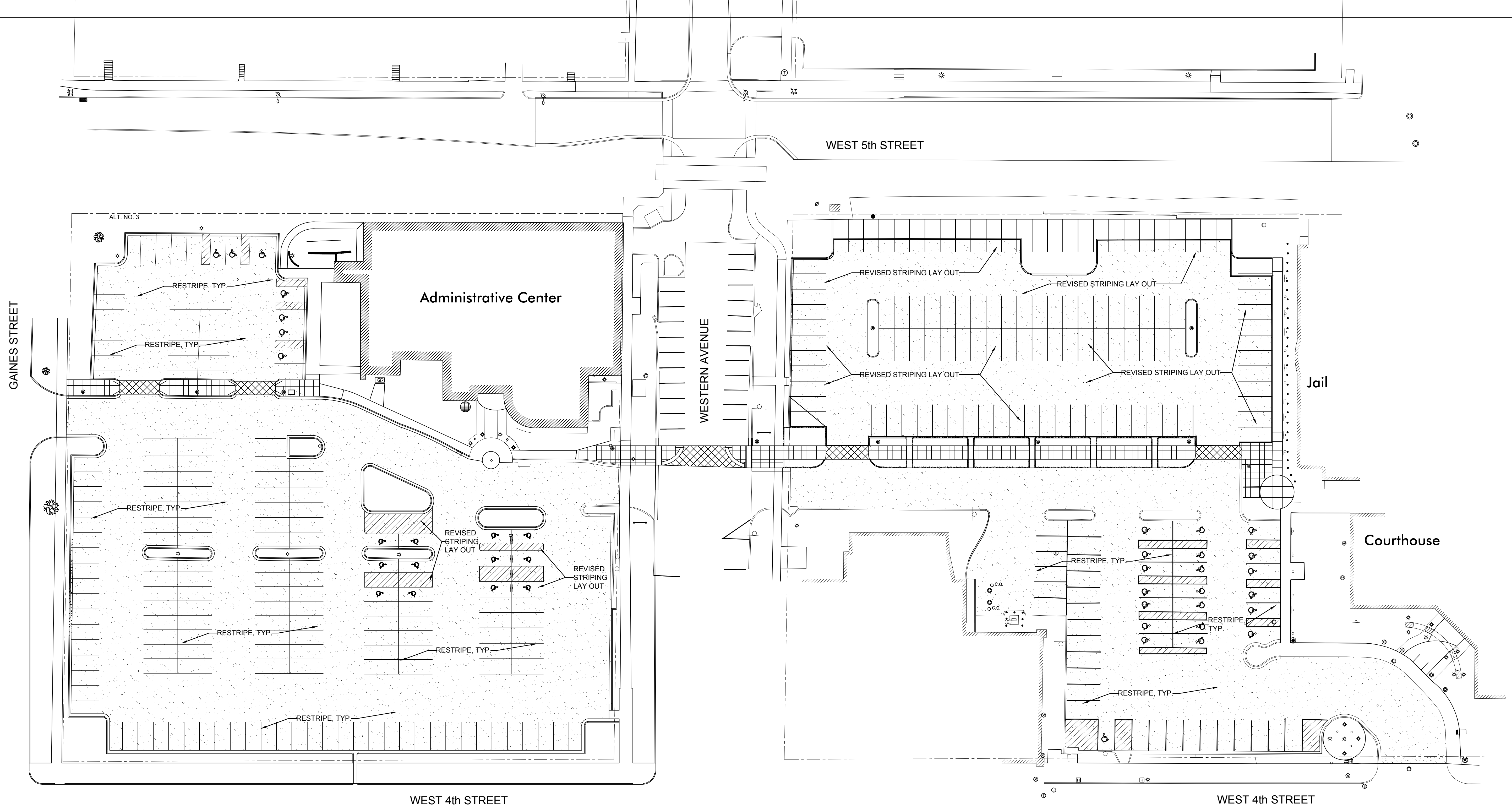

### Sealing and Striping Plan

SCALE: 1"=30'-0"

- NOTES:
1. CONTRACTOR TO VERIFY ALL QUANTITIES, DIMENSIONS, ARRANGEMENTS AND CONDITIONS.
  2. ALL WORK IS BASE BID UNLESS NOTED AS AN ALTERNATE.
  3. F.V. MEANS FIELD VERIFIED BY CONTRACTOR.
  4. CONTRACTOR TO FIELD VERIFY ALL UTILITY LOCATIONS.

CLEAN, REPAIR CRACKS, SEAL CRACKS, SEAL PAVING, RESTRIPE

**NOTE:** DO NOT PROVIDE PAVING SEALER @ CONCRETE PAVING & CONCRETE CURBS. PROVIDE MASKING, ETC.. DO NOT OVERSPRAY. CLEAN ALL CONCRETE OF OVERSPRAY.

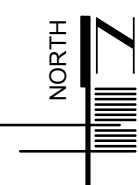



# Questions?

Thank you.

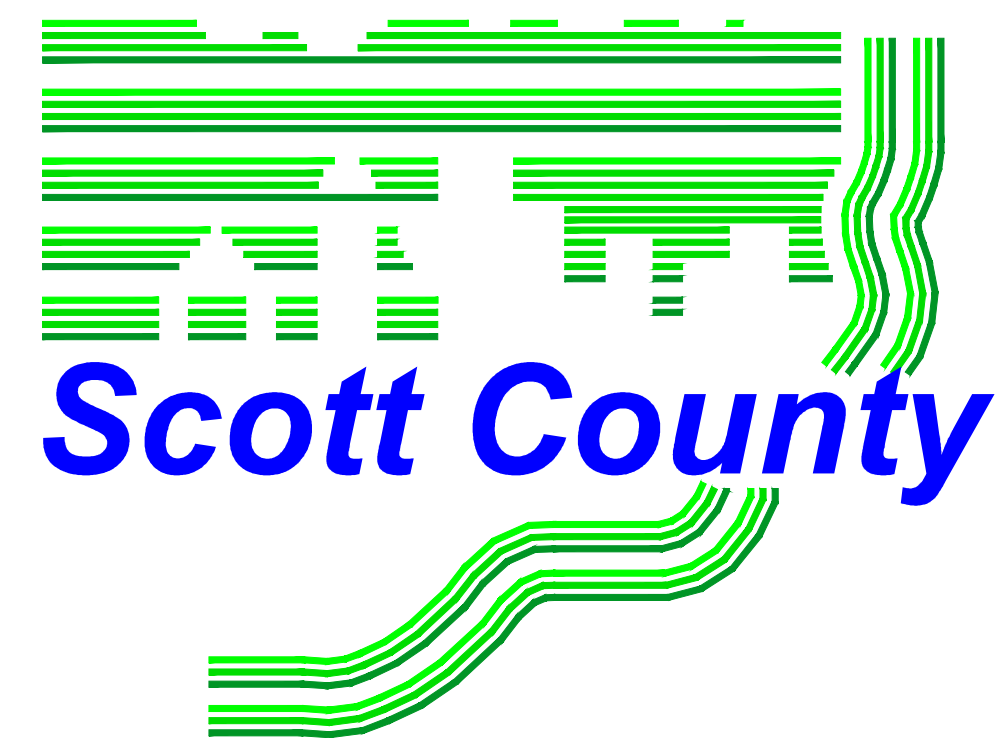

BHMMI

Bracke . Hayes . Miller . Mahon, Architects, LLP  
Moline, Illinois      Davenport, Iowa